

### 9. OBERGESCHOSS

Mietfläche gesamt 9. OG:  
ca. 881 m<sup>2</sup>

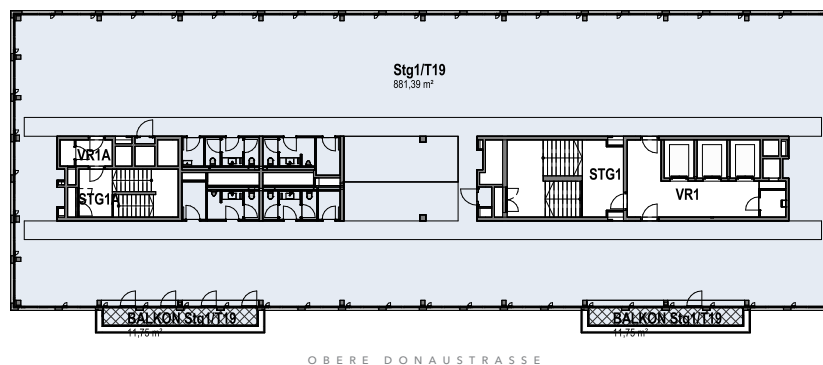

### LAGEPLAN

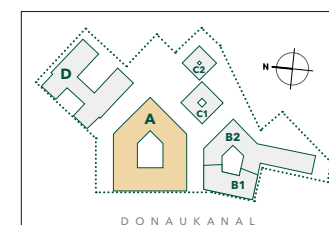

### LeopoldQuartier

Obere Donaustraße 25  
1020 Wien  
[www.leopoldquartier.at](http://www.leopoldquartier.at)

2024-10-11

